

Manual Retractable Bollards

Madoors System

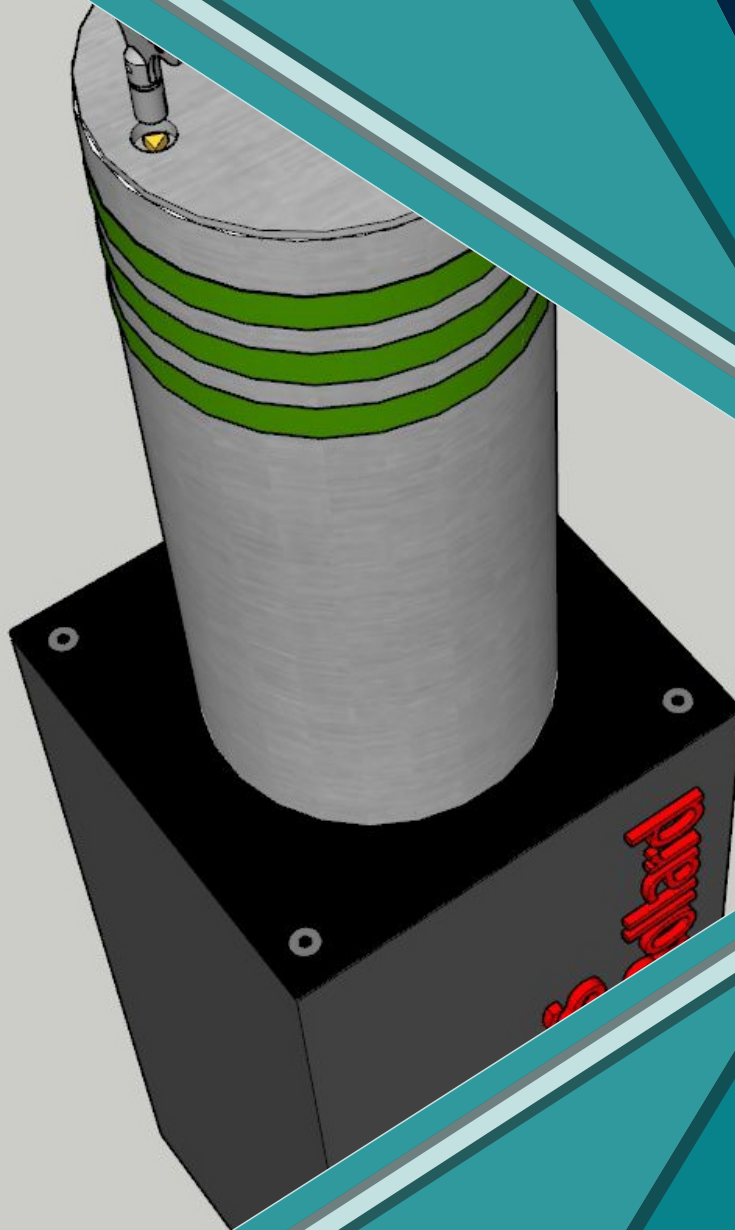

- . Easy to use
- . Strong structure
- . Suitable for intensive use
- . 2 years warranty

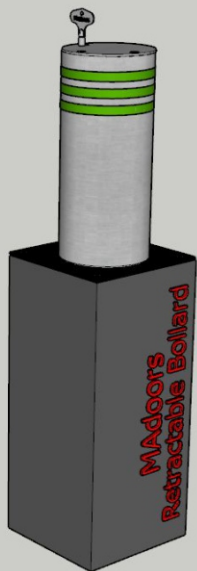
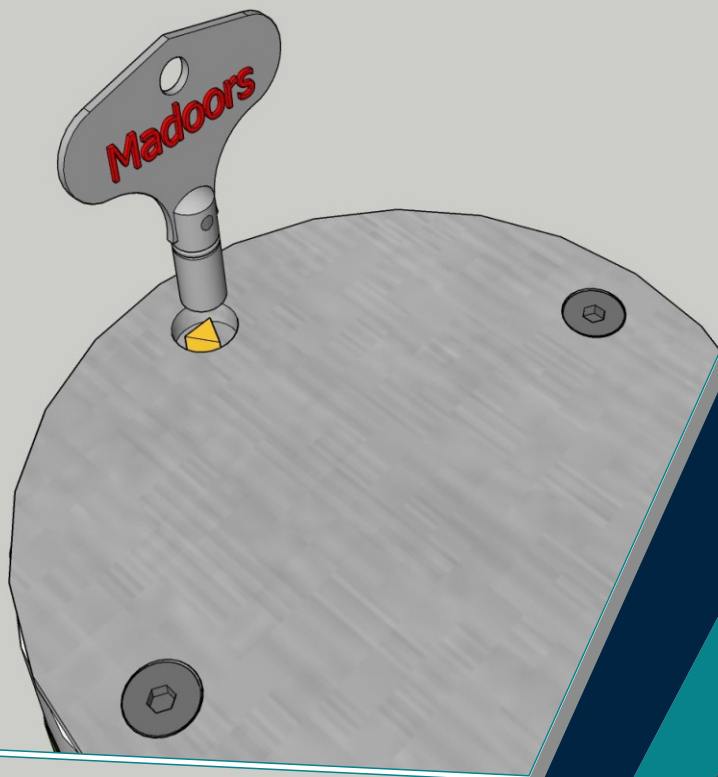

Madoors



1 Institution , Hospital , Universty , Factory , Company at the entrances

2 Easy to Use , Strong Steel Key

3 Hot Dip Galvanized Steel

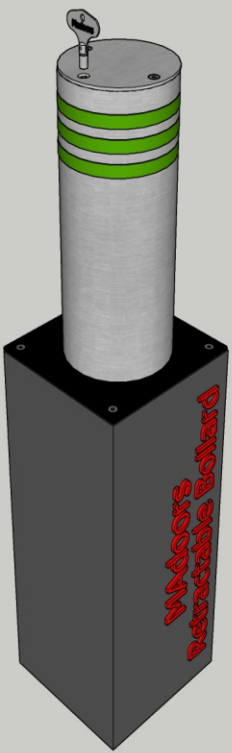
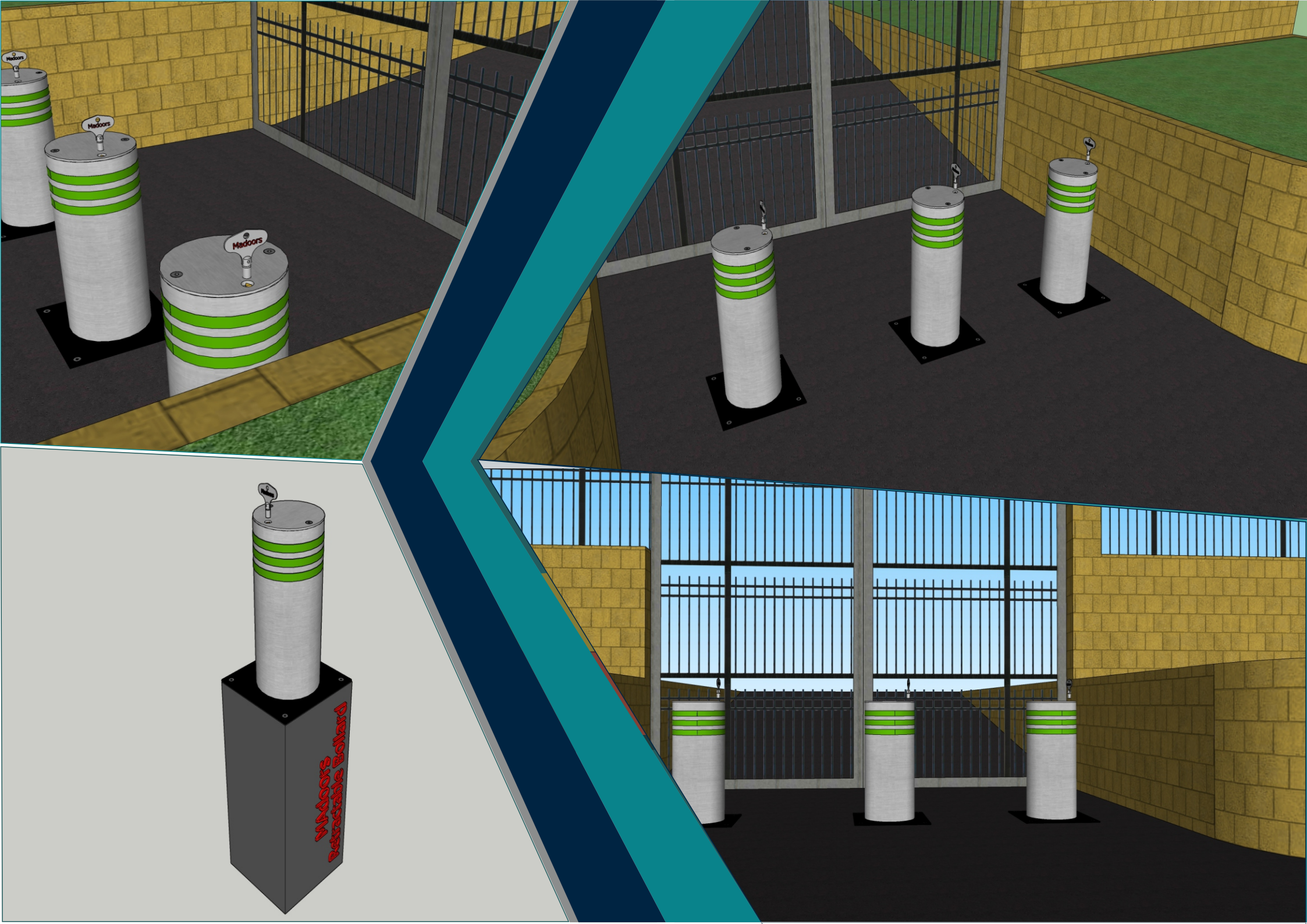

Madoors
Retractable Bollard

TECHNICAL SPECIFICATIONS

Dimensions :

R=220/250 mm.

H=750 mm.

Box Dimensions :

L= 400 mm.

W=400 mm.

H=1000 mm.

Weight : Max. 150 kg

Mechanical Material : Hot Dip Galvanized Steel , Stainly Steel Pipe

Key : Steel Strong Key

Signal: 3 pieces 30 mm. phosphor tape

Screw : Sountersunk screws

Resistance : 130 KJ

